

DISC DRIVE SUSPENSION E4330F**

SILICONE RUBBER / SPECIAL ELECTRONICS /
LOW LOADS

Natural frequency : (1)
20 to 30 Hz



DESCRIPTION

A silicone (VHDS) elastomer with a bonded metal insert. The legs have tangs which enable each leg to be pulled through mounting holes in the equipment. The suspended component can then be attached with an M3 screw through the insert. The tangs can be cut off after insertion.

APPLICATIONS

- Suspension of disc drives.
- Protection of electronic components and printed circuit boards with very low mass in mobile or static environments.

CHARACTERISTICS

Natural Frequency :

- axial : 15 to 30 Hz;
- radial : 15 to 30 Hz.

Amplification factor at resonance < 5.

Operating temperature range : -50°C to +150°C.

Reference	Nominal load (daN)
E4330F01	0,03
E4330F11	0,035
E4330F21	0,036
E4330F31	0,042
E4330F71	0,1

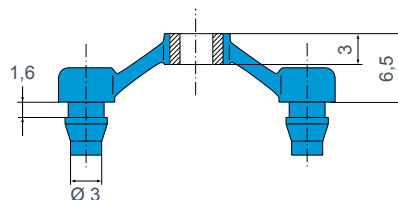

Fixing arrangement

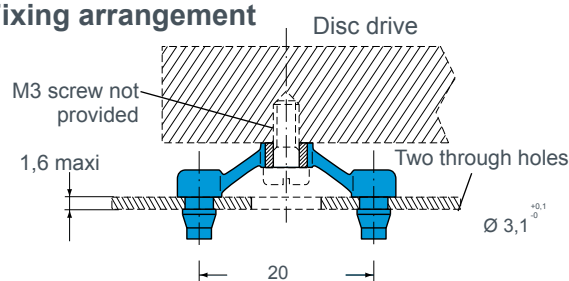

Possible installation configurations :



Mounting in compression



Mounting in shear

1) the indicated natural frequency, are valid for the maxi loads of the ranges of use quoted in the paragraph : TECHNICAL CHARACTERISTICS.